

Construction

Close-coupled self-priming shallow well jet pumps with built-in ejector.

Applications

For drawing water out of a well.
As pressure boosting pump for central water systems with low pressure (follow local specifications if increasing network pressure).
For clean liquids or slightly dirty surface water.
For garden use.
For washing with a jet of water.

Operating conditions

Liquid temperature up to 35 °C.
Ambient temperature up to 40 °C.
Total suction lift up to 9 m.
Maximum permissible working pressure up to 8 bar.
Continuous duty.

Materials

Components	Material
Pump casing	Cast iron GJL 200 EN 1561
Casing cover	Chrome-nickel steel 1.4301 EN 10088 (AISI 304)
Impeller	Brass P-Cu Zn 40 Pb 2 UNI 5705
Wear ring	Chrome-nickel steel 1.4301 EN 10088 (AISI 304)
Diffuser	PPO-GF30 (Noryl)
Ejector	PPO-GF30 (Noryl)
Shaft	Chrome steel 1.4104 EN 10088 (AISI 430)
Mechanical seal	Carbon - Ceramic - NBR

Motor

2-pole induction motor, 50 Hz (n = 2800 rpm).
NGC: three-phase 230/400 V ± 10%.
NGCM: single-phase 230 V ± 10%, with thermal protector. Capacitor inside the terminal box.
Insulation class F.
Protection IP 54.
Constructed in accordance with: EN 60335-2-41.

Characteristic Curves for different suction lifts H_s $n \approx 2800$ rpm

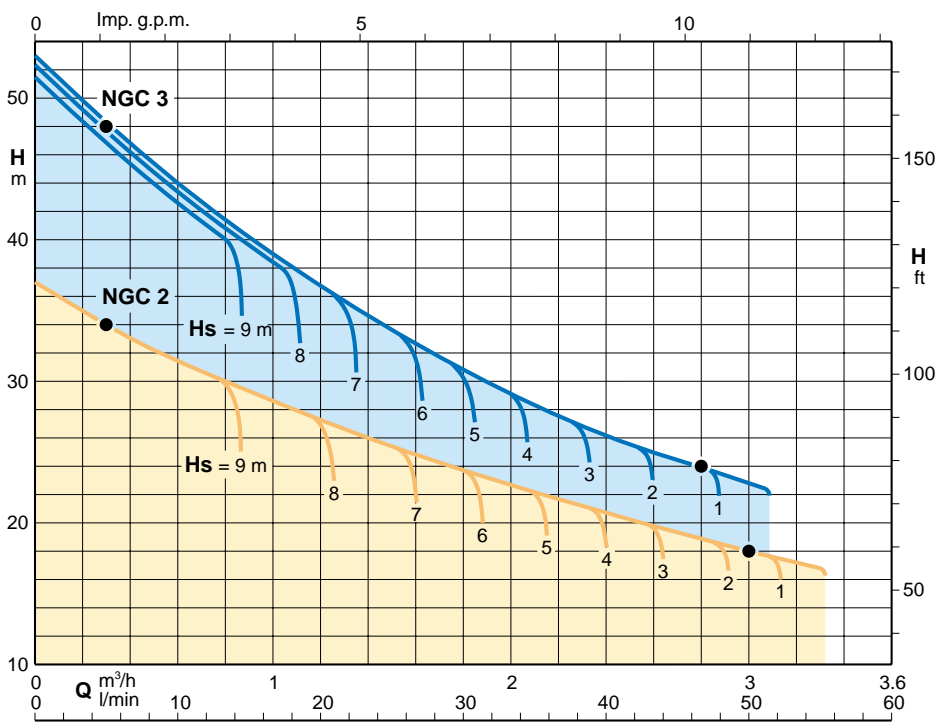

Performance $n \approx 2800$ rpm

TYPE	3~		1~	P1 kW	P2		Q m ³ /h l/min H _s m H m	0	0,25	0,5	0,75	1,0	1,25	1,5	1,75	2,0	2,25	2,5	2,75	3,0	3,25
	230V	400V	230V		kW	HP		0	4,1	8,3	12,5	16,6	20,8	25	29,1	33,3	37,5	41,6	45,8	50	54,1
	A	A	A					H _s	m	9	9	9	8	7	7	6	5	4	3	2	1
NGC 2E	2,8	1,6	-	0,73	0,45	0,6	H m	37	34	32	30	28	27	25	24	22	21	20	19	18	17
NGCM 2E	-	-	3,3																		

TYPE	3~		1~	P1 kW	P2		Q m ³ /h l/min H _s m H m	0	0,25	0,5	0,75	1,0	1,25	1,5	1,75	2,0	2,25	2,5	2,75	3,0
	230V	400V	230V		kW	HP		0	4,1	8,3	12,5	16,6	20,8	25	29,1	33,3	37,5	41,6	45,8	50
	A	A	A					H _s	m	9	9	9	8	7	6	5	4	3	2	1
NGC 3E	2,9	1,7	-	0,9	0,55	0,75	H m	53	49	45	42	39	36	33	31	29	27	25	24	22
NGCM 3E	-	-	4,2																	

H_s: Maximum suction lift for the different capacities Q. P1 Max. power input. P2 Rated motor power output. Tolerances according to ISO 9906, annex A.
H: The head is the sum of the suction lift + delivery head + head losses in the suction and delivery pipelines.

Dimensions and weights

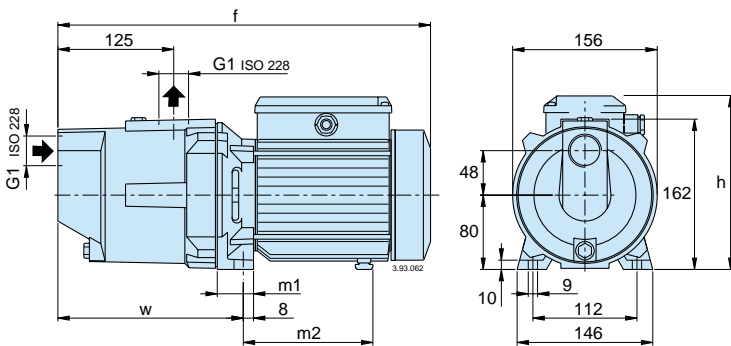

TYPE	mm					kg	
	f	m1	m2	h	w	NGC	NGCM
NGC 2E NGCM 2E	372	34	122	175	200	10,6	10,7
NGC 3E NGCM 3E	404	39	134	188	205	12	13

Self-priming capability

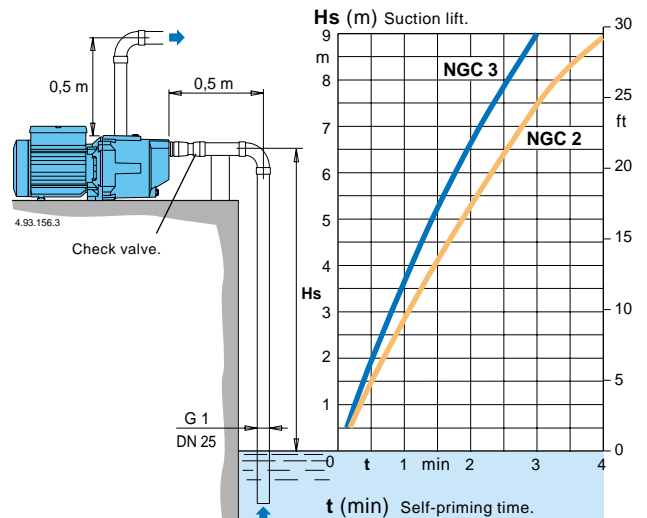

Features

Diffuser with axial flow = fast self-priming up to a suction lift of 9 m.

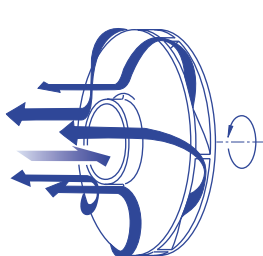

Patented

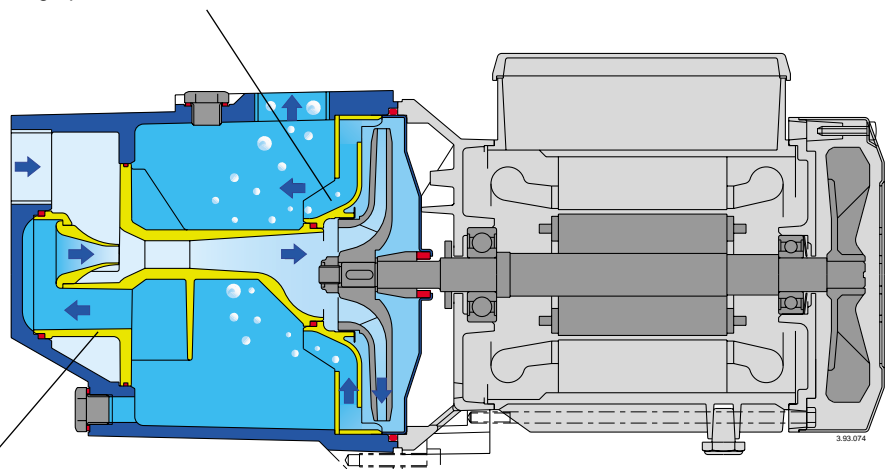

Ejector without closed chambers = total accessibility.